

DIMENSIONS & RECOMMENDED PATTERN

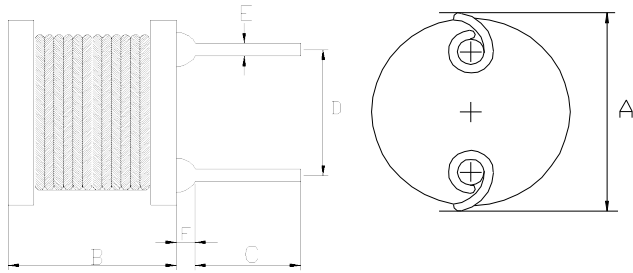

A: 15.0 Max.	mm
B: 16.5 Max.	mm
C: 15.0±2.0	mm
D: 7.5±0.5	mm
E: φ0.8±0.1	mm
F: 2.5 Max.	mm

※FEATURE

Applications:DC-DC converters,LCD Set,OA equipment,notebook, PDA

SELECTION GUIDE FOR STANDARD COILS:

MAGLAYERS PT/NO.	Inductance L(μH)	Percent Tolerance	Test Frequency	Resistance RDC(Ω)Max.	Rated DC Current
					IDC1(A)
GDR-1216-100□	10	K,M	100kHz/0.25V	19m	10.0
GDR-1216-120□	12	K,M	100kHz/0.25V	23m	8.8
GDR-1216-150□	15	M	100kHz/0.25V	27m	8.5
GDR-1216-220□	22	M	100kHz/0.25V	29m	7.0
GDR-1216-101□	100	K,M	100kHz/0.25V	0.15	2.4
GDR-1216-221□	220	K,M	100kHz/0.25V	0.31	1.60
GDR-1216-271□	270	K,M	100kHz/0.25V	0.40	1.45
GDR-1216-331□	330	K,M	100kHz/0.25V	0.46	1.30
GDR-1216-391□	390	K,M	100kHz/0.25V	0.58	1.15
GDR-1216-471□	470	K,M	100kHz/0.25V	0.70	1.00
GDR-1216-561□	560	K,M	100kHz/0.25V	0.75	0.95
GDR-1216-681□	680	K,M	100kHz/0.25V	0.80	0.90
GDR-1216-821□	820	K,M	100kHz/0.25V	0.85	0.80
GDR-1216-102□	1000	K,M	100kHz/0.25V	0.90	0.75
GDR-1216-302□	3000	K,M	10kHz/0.25V	2.79	0.53
GDR-1216-332□	3300	K,M	10kHz/0.25V	2.89	0.52
GDR-1216-402□	4000	K,M	10kHz/0.25V	3.73	0.49

※GENERAL SPECIFICATION:

※□ Specify the inductance tolerance,K(±10%), M(±20%)

※IDC1 : Based on inductance change (ΔL/Lo : drop 10% Max) @ ambient temp. 25°C

IDC2 : Based on temperature rise (ΔT : 40°C TYP.)

Rated DC Current : The less value which is IDC1 or IDC2.